

TRACK LINK PIN PUSHER

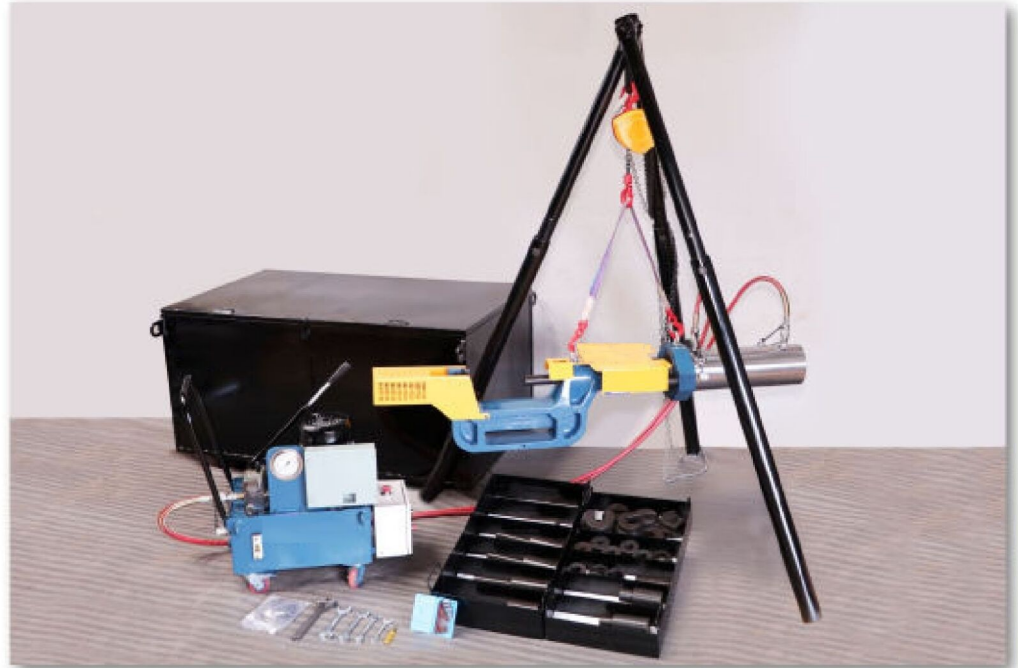

FEATURES

- 01 Removal and Installations of Track Link Pins & Bushes
- 02 Maintenance of Track Chains in Workshops and On Site
- 03 Tooling Sizes suit Pin Sizes of all Brands of Earth Moving Equipment
- 04 Frame is made of High Grade Heat Treated Alloy Steel Casting
- 05 Operated By : Hand Pump / Hydraulic Powerpack with Stand By Hand Pump
- 06 Optional Sprocket Puller for 100Ton Pin Pusher
- 07 Safety Guards for Operator Safety.
- 08 20 Ton Flat Jacks come as a standard accessory for bush removal
- 09 Optional Tripod and Chain Pulley Block Assembly for Lifting of Pin Pusher during Operation
- 10 Tooling for 1 Pin Size consists of Pushing Pin, Forcing Pin, Aligning Adaptor, Guide Bushes



+91 - 97403 26890

sales@bemcojack.com

www.bemcojack.com

Khanapur Road,
Udyambag, Belgaum
590008, Karnataka
INDIA

SPECIFICATIONS

Pin Pusher Model and Specifications

Capacity (Metric Ton)	Stroke (mm)	Model	Length (mm)	Width (mm)	Height (mm)	Approx Weight (kg)	Pin Dimensions		Optional Tripod And Chain Pulley Block Capacity (Metric Ton)
							Mix (mm)	Max (mm)	
50	250	TPP-50/250	1455	255	295	200	19.3	36.4	1 Ton
100	350	TPP-100/350	1830	340	330	233	19.3	60.2	1 Ton
150	350	TPP-150/350	2050	420	375	490	22	70	1 Ton
200	350	TPP-200/350	2200	460	390	532	19.3	76.3	2 Ton

Pumping Unit Models

Model	Hand Pump	Powerpack	
		(50 Hz)	(60Hz)
TPP-50/250	HP-02/6	BJP-2/1/25/HP	BJP-2/1.2/25//HP
TPP-100/350	HP-02/13	BJP-2/1/25/HP	BJP-2/1.2/25//HP
TPP-150/350	HP-02/13	BJP-3/1.5/25/HP	BJP-2/1.2/25//HP
TPP-200/350	HP-02/13	BJP-3/1.5/25/HP	BJP-2/1.2/25//HP

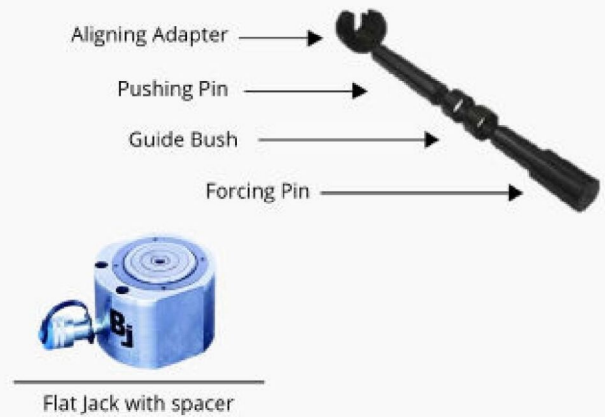

Hand Pump Specifications and Pin Pusher Operating Speeds:

'BEMCO JACKS' make Two Stage High Pressure Hydraulic Pumps, with Automatic Changeover from Low Pressure to High Pressure, with inbuilt Pressure Relief Valve, Release Valve, Rotary DC Valve, Pressure Gauge and Quick Change Couplers, with following specifications:

Model	Low Pressure Discharge (cc/stroke)	High Pressure Discharge (cc/stroke)	Oil Tank Capacity (Liters)	Max. Pressure (Bar)
HP-02/6	48	2.8	6	700
HP-02/13	48	2.8	13	700
Speeds for TPP Models with Hand Pump				
Model	Forward		Return Idle Stroke (mm/stroke)	
	Idle Stroke (mm/stroke)	At 700 Bar (mm/stroke)		
TPP-50/250	6.1	0.35	7.2	
TPP-100/350	3.1	0.18	3.8	
TPP-150/350	2.1	0.12	2.7	
TPP-200/350	1.5	0.1	1.7	



Hydraulic Powerpack Specifications and Operating Speeds:

'BEMCO JACKS' make Hydraulic Powerpack to operate Master Pin Pushers consists of High Pressure Radial Piston Pump, Coupled to Electric Motor.

Pressure Relief Valve, Hand Operated DC Valve, Check Valve are mounted on a compactly designed manifold.

Glycerine Filled Pressure Gauge is mounted in a ergonomically designed Panel. Suction Strainer, Return Line Filter, Filler Cum Breather, Oil Level Indicator are provided to ensure sufficient and clean oil is running through the system.

Starter Box consists of Push Buttons for Motor ON and OFF along with Emergency Switch.

A Stand By Hand Pump is provided in the Powerpack, to operate the equipment in case of unavailability of Electric Power on Site.

The Powerpack is mounted on Castor Wheels for ease of movement. Quick Change Couplers are a standard feature for Plug and Play Operation:

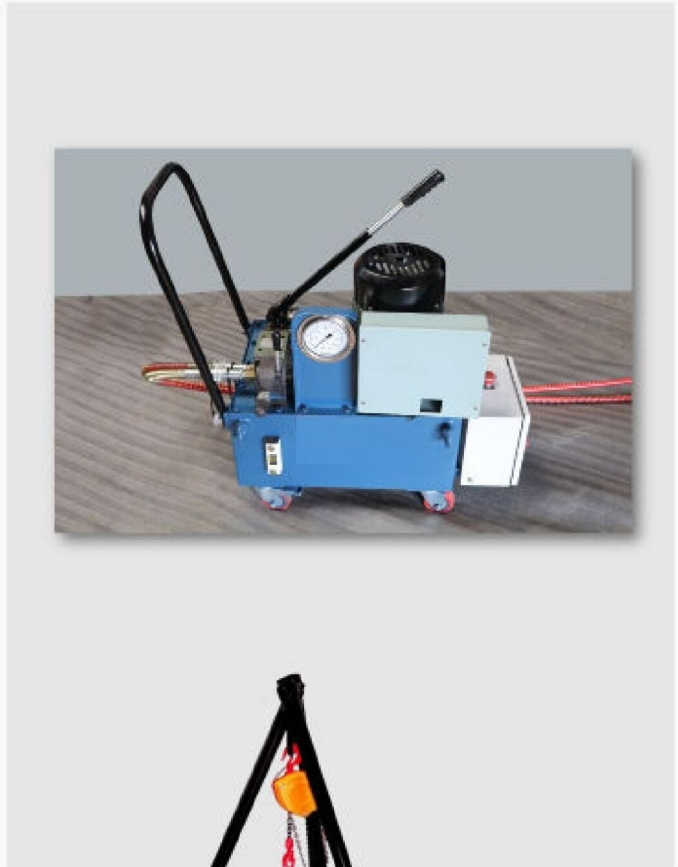

MODEL	Motor Capacity (HP)	Pump Flow		Max Pressure (Bar)	Oil Tank Capacity (Liter)	Speeds			
		50Hz (LPM)	60Hz (LPM)			50Hz Motor		60Hz Motor	
						Forward (mm/sec)	Return (mm/sec)	Forward (mm/sec)	Return (mm/sec)
TPP-50/250	2	1	0.74	650	25	2.1	2.5	2.5	3
TPP-100/350	2	1	0.74	650	25	1.1	1.32	1.3	1.6
TPP-150/350	3	1.5	1.2	650	25	1.1	1.4	0.9	1.1
TPP-200/350	3	1.5	1.2	650	25	0.8	0.9	0.7	0.7

NOTE : FOR 150 Ton & 200 Ton Motor is 2HP for 60 Hz.

GENERAL SCOPE OF SUPPLY WITH EACH MODEL

- Master Pin Pusher with Safety Guards fitted with Quick Change Couplers and Inbuilt Pressure Relief Valve
- Hydraulic Pumping Unit – Hand Pump / Powerpack
- 2 Nos. of High Pressure Flexible Hose Pipe with Spring Guard. End Connections: 3/8" NPT with Hose Adaptor. Working Pressure: 700 Bar and Length: 4 meters each
- Set of Toolings for Pin Removal and Assembly : Consisting of Pushing Pin, Forcing Pin, Aligning Adaptor, Guide Bushes:
 - a. 50 Ton : 4 Sets of Tooling suitable for various pin sizes
 - b. 100 Ton : 10 Sets of Tooling suitable for various pin sizes
 - c. 150 Ton : 12 Sets of Tooling suitable for various pin sizes
 - d. 200 Ton : 15 Sets of Tooling suitable for various pin sizes
- Flat Jack: Capacity 20 Metric Ton, 12 mm stroke, with Quick Change Coupler and Spacers
- Spanner Set and Allen Key
- Spare Set of Seals for Pin Pusher Cylinder and Flat Jack
- Spare Set of Relief Valve for Powerpack and Rotary DC Valve for Hand Pump
- Optional Tripod Assembly consisting of:
 - a. Tripod
 - b. Chain Pulley Block
 - c. Slings with Hook
- Re-usable Carrying Case for Entire Equipment



CONTACT



BEMCO JACKING SYSTEMS PVT. LTD.

ISO 9001-2015 certified company

Regd. Office and Work Address

 Khanapur Road, Udyambag, Belgaum 590008 - INDIA

 0831 - 2441019 / 2441388

 sales@bemcojack.com

 www.bemcojack.com

